

*A Rare Address*

FOR A REFINED LIFE

ABOVE  
THE

*Rare*



A balcony with various potted plants in the foreground, overlooking a city skyline shrouded in mist. The text 'The World!' is written in a green, cursive font across the middle of the image.

The World!

SKYHIGH

Rising beyond the ordinary skyline. Here, the city slowly fades beneath it.

Balconies open to endless skies, rising on higher ground, which leaves the city behind earlier than expected. Views unfold generously, where even lower floors feel remarkably elevated.

Where height is not a number, but by how far the world feels below.

OPEN UP  
THE

*Rare*





# Window!

## SKYHIGH

Set beside rolling greens and open hills, this breathes with a quiet rhythm of its own. Air flows freely through three open sides, carrying light gently into every corner. Silence does not feel distant here; it feels natural, almost intended. Perfectly connected to the world, yet gracefully removed from its noise.



EXPERIENCE THE

*Breathtaking*



*Beauty.*

## SKYHIGH

Step into a realm where the horizon stretches infinitely, inviting you to lose yourself in a tapestry of vivid colors and majestic silhouettes. This is more than a view; it is a profound invitation to reconnect with the earth's raw elegance and find tranquility within the grandeur of the great outdoors.

WHERE RARITY

*Lives*

An aerial view of a city skyline at sunset, with a network of glowing orange lines overlaid on the buildings. The word "Forever" is written in a white, cursive font across the center of the image.

Forever

A teal background with a white cloud in the upper left corner.

SKYHIGH

This is where mornings begin without traffic, and work stands just a few steps away. Corporate energy surrounds it, yet calm quietly defines it. Everything essential feels within reach, while the noise of the city stays respectfully distant. Here, connection is effortless, and living remains undisturbed.

*A Rare* EXCEPTIONAL LIFESTYLE!





# SKYHIGH

## TOWERS

Adj. Infosys-II, Hinjewadi

### **2 & 3 BHK RESORT HOMES**

Rising adjacent to Infosys-II in the heart of Hinjewadi's most dynamic corridor. Designed across 34 storeys, it stands among the highest altitude towers in the locale, opening to uninterrupted sky and sweeping hill views. Three-sided open residences invite cross-ventilation, abundant daylight, and expansive perspectives into everyday living. With walk-to-work convenience, curated lifestyle amenities, and a setting wrapped in greenery, it balances ambition with calm. Not Simply Well Placed, It Is A Rare Exception.



**DESIGNED TO**

*Rise Above*



Thoughtfully planned livingrooms offer optimal spaceutilization, natural ventilation,and comfortable layouts, while well-designed kitchens ensure efficient movement, ample storage, and modern functionality for everyday ease. If you want it even tighter or more premium-sounding, I can refine it further.

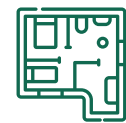

**Bold  
Design**



**Cost Effective  
Maintenance**



## THOUGHTFULLY PLANNED

# Amidst Nature

The project is planned within a naturally green environment, offering well-distributed open spaces and landscaped areas that enhance ventilation, daylight access, and thermal comfort. Carefully positioned lifestyle amenities are integrated across the layout to ensure easy accessibility while preserving privacy and visual openness. Pedestrian-friendly zones, recreational areas, and green buffers create a balanced environment that supports relaxation, wellness, and active living.



3-Sided Open  
Apartments



Elegant Facade With  
Contemporary Elevation



Superior Cross-ventilation  
And Natural Airflow





# *Lifestyle Amenities*

## THAT MOVES WITH YOU

---

At Club High, life is designed to keep you active, relaxed, and socially connected. From professional sports facilities to spaces for recreation and entertainment, every amenity is thoughtfully crafted to bring joy, wellness, and vibrant community living into your everyday life. Whether it's a competitive match, a refreshing swim, or quality time with family, the lifestyle here keeps your days energetic and your evenings refreshing.



KIDS PLAYGROUND



INFINITY SWIMMING POOL



 CYCLING TRACK





TENNIS COURT



FUTSAL GROUND



VOLLEYBALL COURT



 BASKETBALL COURT



 BADMINTON COURT



FOOTBALL GROUND



SKY GARDEN AERIAL VIEW



SKY GARDEN

# SKYHIGH TOWERS

Adj. Infosys-II, Hinjewadi

## ODD FLOOR PLAN

### WING D - 1

Unit Number	Unit Type	Facing	Carpet Area	Balcony Area	Open Balcony	Entrance	Terrace	Total
			A	B	C	D	E	A+B+C+D+E
301, 501, 901, 1101, 1301, 1501, 1901, 2101, 2301, 2501 2901 3101, 3301	2 BHK	Garden	44.38	3.85	5.19	1.36	2.94	625
302, 502, 902, 1102, 1302, 1502, 1902, 2102, 2302, 2502, 2902, 3102, 3302	3 BHK		67.3	0	7.7	1.29	3.22	855
303, 503, 903, 1103, 1303, 1503, 1903, 2103, 2303, 2503, 2903, 3103, 3303	3 BHK	Hill	67.3	0	7.7	1.29	3.22	855
304, 504, 904, 1104, 1304, 1504, 1904, 2104, 2304, 2504, 2904, 3104, 3304	2 BHK		44.38	3.85	5.19	1.36	2.94	625



# SKYHIGH

TOWERS

Adj. Infosys-II, Hinjewadi

## EVEN FLOOR PLAN

### WING D - 2

Unit Number	Unit Type	Facing	Carpet Area	Balcony Area	Open Balcony	Entrance	Terrace	Total
			A	B	C	D	E	A+B+C+D+E
201, 401, 601, 801, 1001, 1401, 1601, 1801, 2001, 2401, 2601, 2801, 3001, 3401	2 BHK	Garden	47.99	0	5.19	1.36	0	590
202, 402, 602, 802, 1002, 1402, 1602, 1802, 2002, 2402, 2602, 2802, 3002, 3402	2 BHK		44.86	3.13	5.19	1.36	0	590
203, 403, 603, 803, 1003, 1403, 1603, 1803, 2003, 2403, 2603, 2803, 3003, 3403	2 BHK		44.86	3.13	5.19	1.36	0	590
204, 404, 604, 804, 1004, 1404, 1604, 1804, 2004, 2404, 2604, 2804, 3004, 3404	2 BHK	Hill	47.99	0	5.19	1.36	0	590



**SKYHIGH**  
TOWERS  
Adj. Infosys-II, Hinjewadi

**TYPICAL EVEN FLOOR PLAN**

**WING D - 3**

Unit Number	Unit Type	Carpet Area	Balcony Area	Terrace Area	Total Carpet Area	Carpet Area (Sq. Ft.)
		A	B	C	A+B+C	
201, 401, 601, 801, 1001, 1401, 1601, 1801, 2001, 2401 2601 2801, 3001	2 BHK	54.75	6.75	0	61.5	662
202,402. 602, 802, 1002, 1402, 1602, 1802, 2002, 2402, 2602, 2802, 3002, 3402	2 BHK	54.75	6.75	0	61.5	662
203, 403, 603, 803, 1003, 1403, 1603, 1803, 2003, 2403, 2603, 2803, 3003, 3403	2 BHK	54.75	6.75	0	61.5	662
204, 404, 604, 804, 1004, 1404, 1604, 1804, 2004, 2404, 2604, 2804, 3004, 3404.	2 BHK	54.75	6.75	0	61.5	662

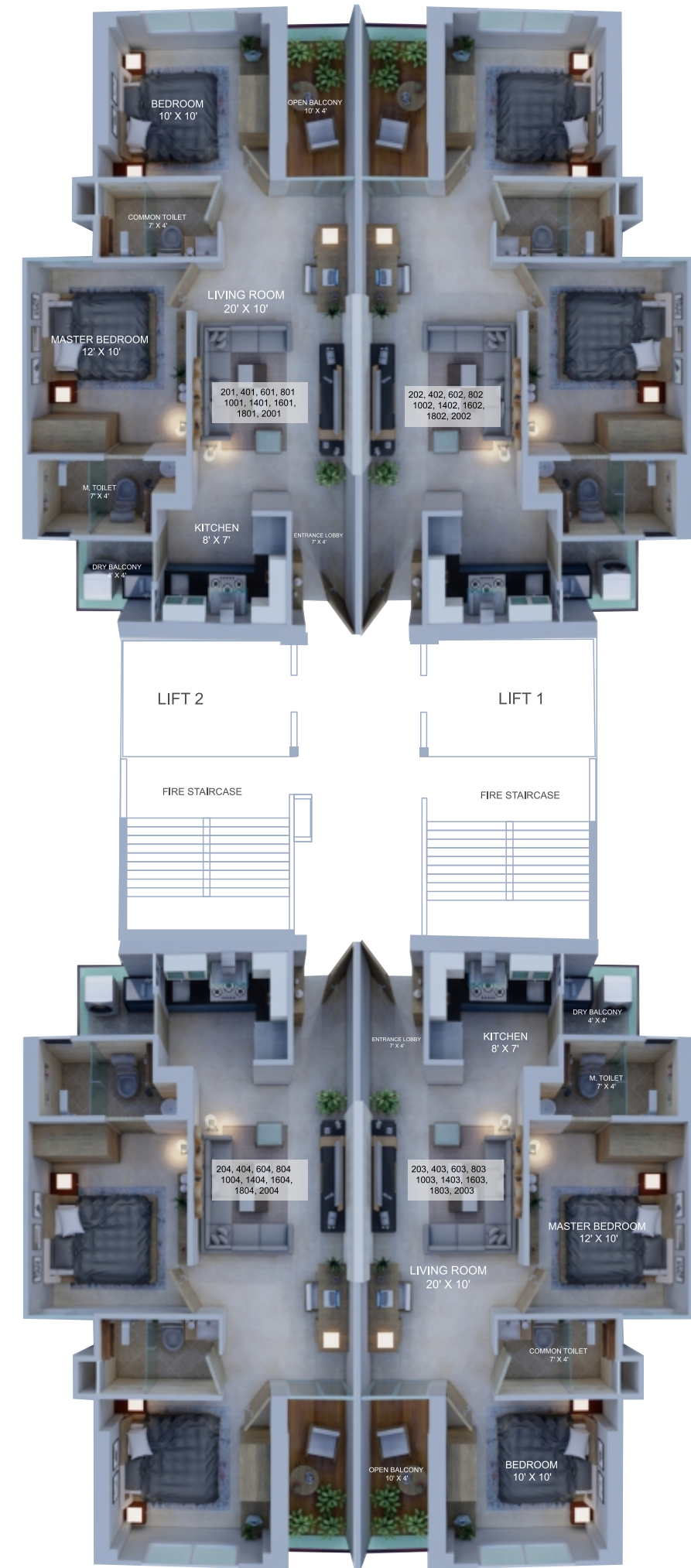

**SKYHIGH**  
TOWERS  
Adj. Infosys-II, Hinjewadi

**TYPICAL ODD FLOOR PLAN**

**WING D - 3**

Unit Number	Unit Type	Carpet Area	Balcony Area	Terrace Area	Total Carpet Area	Carpet Area (Sq. Ft.)
		A	B	C	A+B+C	
301, 501, 901, 1101, 1301, 1501, 1901, 2101, 2301, 2501, 2901, 3101, 3301	2 BHK	54.75	6.75	2.43	63.93	688
302, 502, 902, 1102, 1302, 1502, 1902, 2102, 2302, 2502, 2902, 3102, 3302	2 BHK	54.75	6.75	2.43	63.93	688
303, 503, 903, 1103, 1303, 1503, 1903, 2103, 2303, 2503, 2903, 3103, 3303	2 BHK	54.75	6.75	2.43	63.93	688
304, 504, 904, 1104, 1304, 1504, 1904, 2104, 2304, 2504, 2904, 3104, 3304	2 BHK	54.75	6.75	2.43	63.93	688

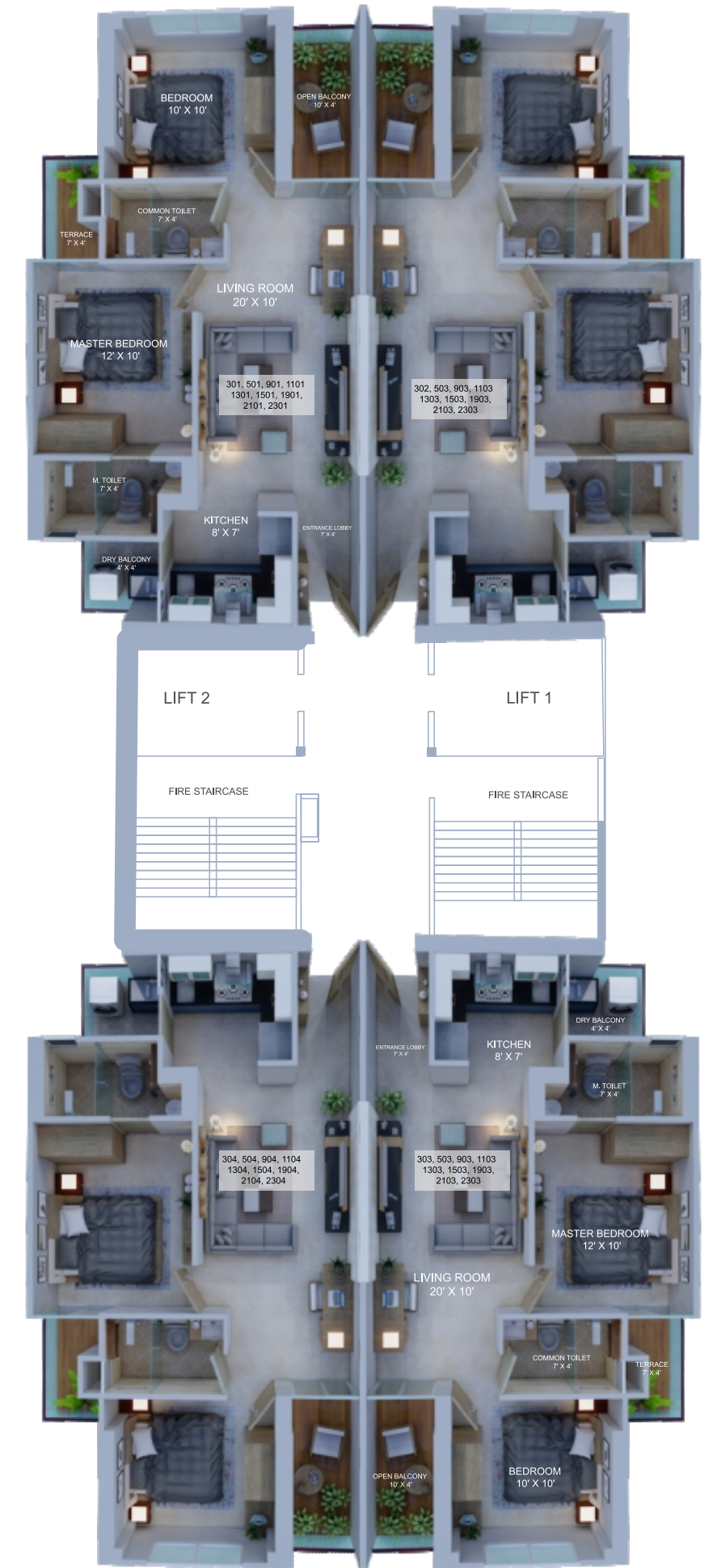

**SKYHIGH**  
T O W E R S  
Adj. Infosys-II, Hinjewadi

**2 BHK PEARL - 662 SQ. FT.**

**WING D - 3**



# SKYHIGH

TOWERS  
Adj. Infosys-II, Hinjewadi

**2 BHK EMERALD - 688 SQ. FT.**

**WING D - 3**



LIVE THE

*Rare*



A person in a light blue shirt is shown from the side, reaching out with their right hand towards a vast landscape. The landscape features a cityscape below, a sea of white clouds in the middle ground, and rugged mountains in the background under a clear blue sky. The word 'Access' is written in a white, elegant cursive font across the middle of the image, with the person's hand appearing to touch the end of the word.

Access

**Above the Noise.  
Close to Everything.**

**SKYHIGH**

Positioned adjacent to Infosys Phase II, Hinjewadi, and perched at the highest altitude in the area, this address offers sweeping valley views, refreshing openness, and effortless connectivity to the city's most important destinations.

WELL CONNECTED.

*Naturally Peaceful*





## LOCATION

### IT SECTORS

Infosys	2.6 KM
Quadron	2.9 KM
Wipro	3.0 KM
Tech Mahindra	3.3 KM
TCS	3.4 KM
Cognizant	4.2 KM
Cisco	5.9 KM

### SCHOOLS

Blue Ridge Public School	8.0 KM
Vibgyor School	4.6 KM
Ryan International	1.7 KM
Pawar Public School	4.4 KM
Mercedes Benz School	6.6 KM

### HOSPITALS

Hinjawadi Hospital	4.8 KM
Shatayu Hospital	5.4 KM
Life Tree Hospital	5.6 KM
Ruby Hall Clinic	7.1 KM

### HOTELS

Mezza 9	4.6 KM
Lemon Tree	6.0 KM
Courtyard Marriott	6.1 KM
Fortune Inn Exotica	6.1 KM

### BANKS

ICICI Bank	8.0 KM
Bank of India	9.1 KM
HDFC Bank	4.2 KM
SBI Bank	4.7 KM

### MALLS

Grand Highstreet	4.4 KM
D-mart Mall	5.7 KM
Xion Mall	5.7 KM

### METRO STATIONS

Dohler Metro Station	2.0 KM		Infosys Metro Station	2.6 KM		Hinjewadi Metro Station	6.0 KM
----------------------	--------	--	-----------------------	--------	--	-------------------------	--------

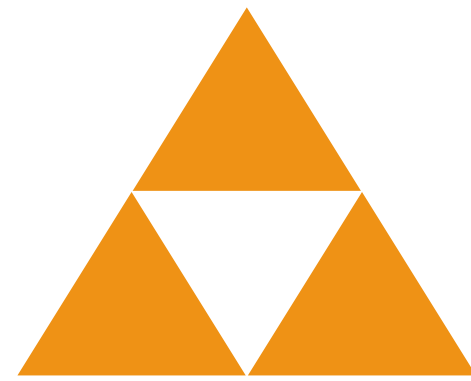

MITTAL<sup>®</sup>  
BROTHERS

*You first.*

WHERE YOU *Come First.*

Mittal Brothers is a name synonymous with trust, quality, and thoughtful development. With decades of expertise in shaping Pune's real estate landscape, the company is driven by a customer-first philosophy—where innovation, fine detailing, modern design, and timely delivery come together seamlessly. From residential to commercial developments, every Mittal Brothers project reflects a legacy of distinction, built around the belief that when customers come first, everything else follows.

10K+

HAPPY FAMILIES

5.8M+

SQ.FT AREA DEVELOPED

31+

PROJECT DELIVERED

45+

YEARS OF EXCELLENCE

Honouring a  
*Legacy of Excellence*



# COMPLETED PROJECTS

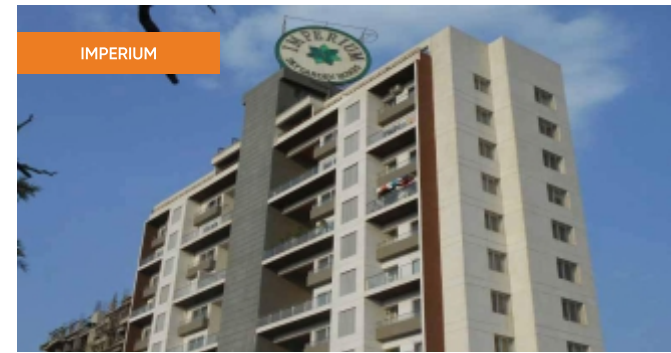



ONE PLACE, WANOWRIE



ONE PLACE, WAKAD



HIGH MONT



AKSHARDHAM

## ONGOING PROJECTS

### RESIDENTIAL PROJECTS



ARCVISTA



SKYHIGH

### COMMERCIAL PROJECTS



ONE PLACE, FC ROAD

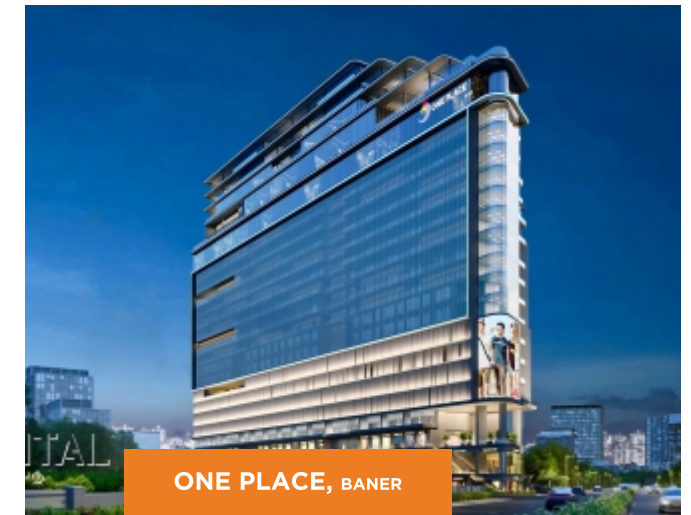

ONE PLACE, BANER



MahaRERA Registration No  
**P52100048413**  
<https://maharera.maharashtra.gov.in/>



MahaRERA Registration No  
**P52100048403**  
<https://maharera.maharashtra.gov.in/>



**MITTAL<sup>®</sup>**  
**BROTHERS**

*You first.*

[info@mittalbrothers.com](mailto:info@mittalbrothers.com) | 9850 66 44 99

Site Address: S. No. 277, Next to Virgo Engineers, Adj. to Infosys II, Maan, Hinjewadi, Pune.

[www.skyhightowers.com](http://www.skyhightowers.com)